

HISTORICAL RECORDS IN THE LOUISA COUNTY COURTHOUSE

A guide to location of records in 2015

The Louisa County Historical Society

Main Floor

- Enter from the back side of the courthouse (parking is available across street.)

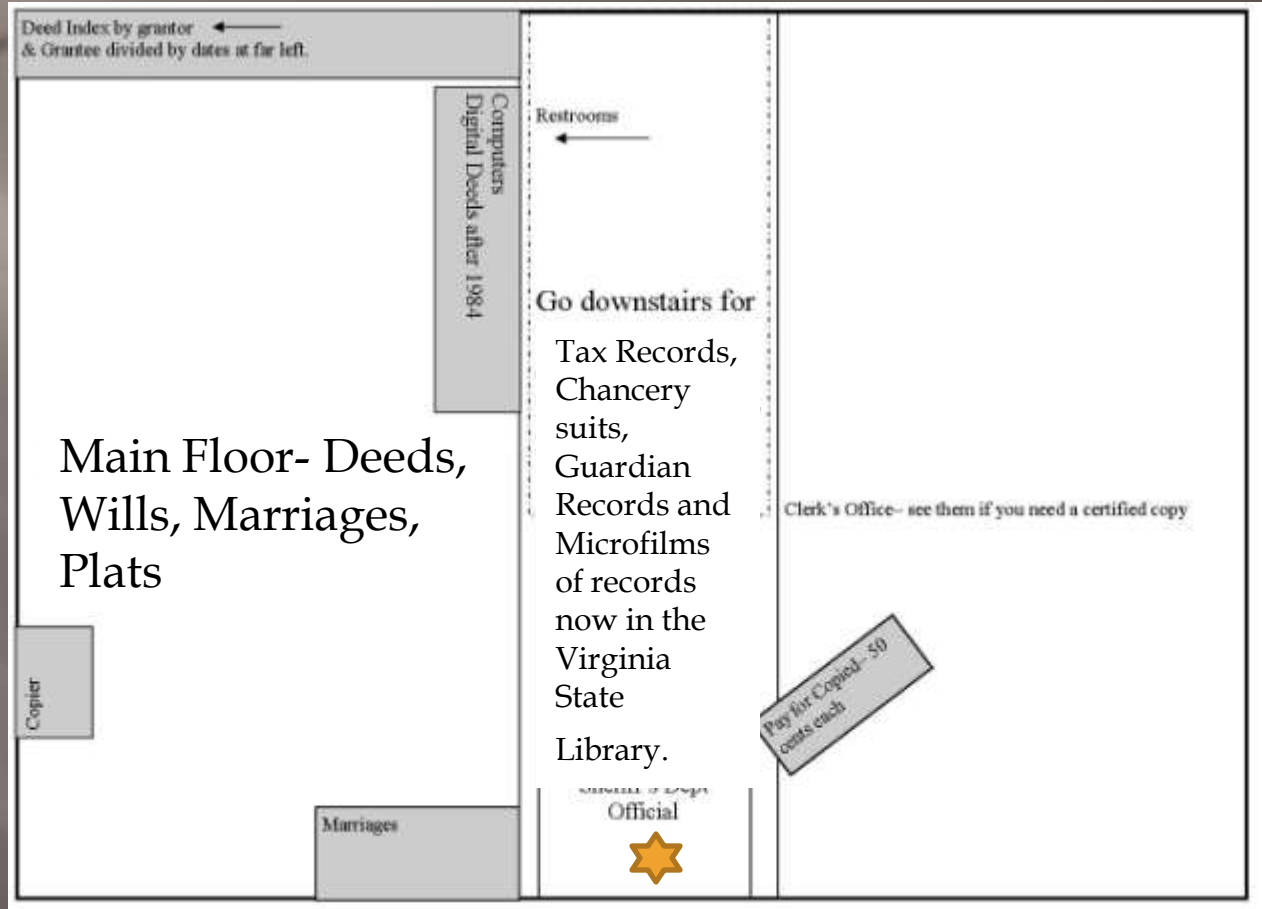



Record Room

- ▣ Against the far back wall, left stack are the grantor and grantee index books. Deeds from 1984 forward are found on the computers in the room. Will are in the low stacks in the center of the room.

Hint- Abstracts of pre-1800 deeds and wills are in print at our public library or museum. Many more deeds are online at

<http://trevilians.com/deeds/deedmain.htm>



- ▣ Deed Books were indexed by hand. You will find, for example, Walton in the Wa pages. They will not all be together, so look carefully. Deed books also contain various contracts 'duly recorded' and a few plats.



Marriages from 1766

- When you enter the Deed Room, marriage records are on the wall just to your left. The clerk will give you a form to use if you need a certified copy.

Plats

Modern deeds are recorded with plats, but such was not the case in earlier times. Those which exist are in plat books near the copier.



Also Available

- ▣ Wills – many abstracts are indexed online at <http://trevilians.com/probate/willmain.htm>
- ▣ Tax Records- 1782 Personal Property records are online free at <http://www.binnsgenealogy.com/FreeSample/CDR-000429/1782/>
- ▣ Chancery suits (to settle estates and often loaded with genealogical treasures.) From 1742-1914 are online at <http://www.lva.virginia.gov/chancery/>

Lower Level

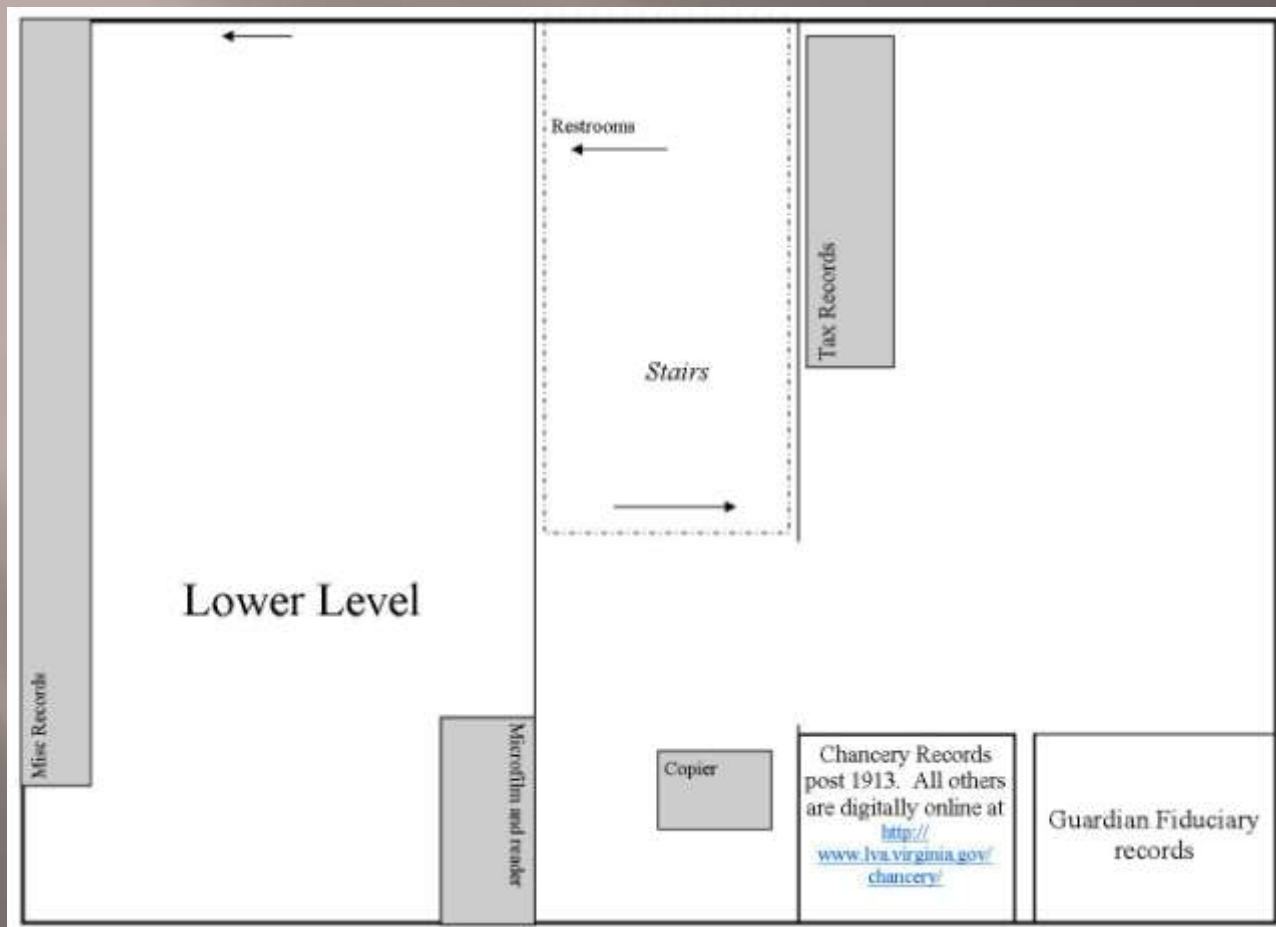



Chancery Suits

- ▣ Records from 1753-1913 are beautifully scanned online at <http://www.lva.virginia.gov/chancery/>. Later records are still at the courthouse. There is an index in the chancery room.

Please help us preserve our 270 year old treasures

- ▣ *A word from all who want our records to exist for the next generation. As you will see downstairs, many of our records are in jeopardy from age and deteriorated condition. At this point, signs are posted prohibiting digital cameras. Will you join us in not damaging our fragile, oldest books by making photocopies? If at all possible, please take notes instead...see examples of distressed records on next page.*



Handle with
great care



Many of Louisa County's original records going back to 1742 are still in the courthouse and, as public records, are not protected except by the care we give them.

Wills and Guardian Books

Wills are located upstairs in the Deed Room...see map. Guardian books record the funds paid, even by a mother, for the care of children whose father had died. They are an often overlooked source of information.



Will Books

- ▣ Indexed by year, these books contain both wills and estate settlements. As with deed books, the index directs you to the book and page of each record.

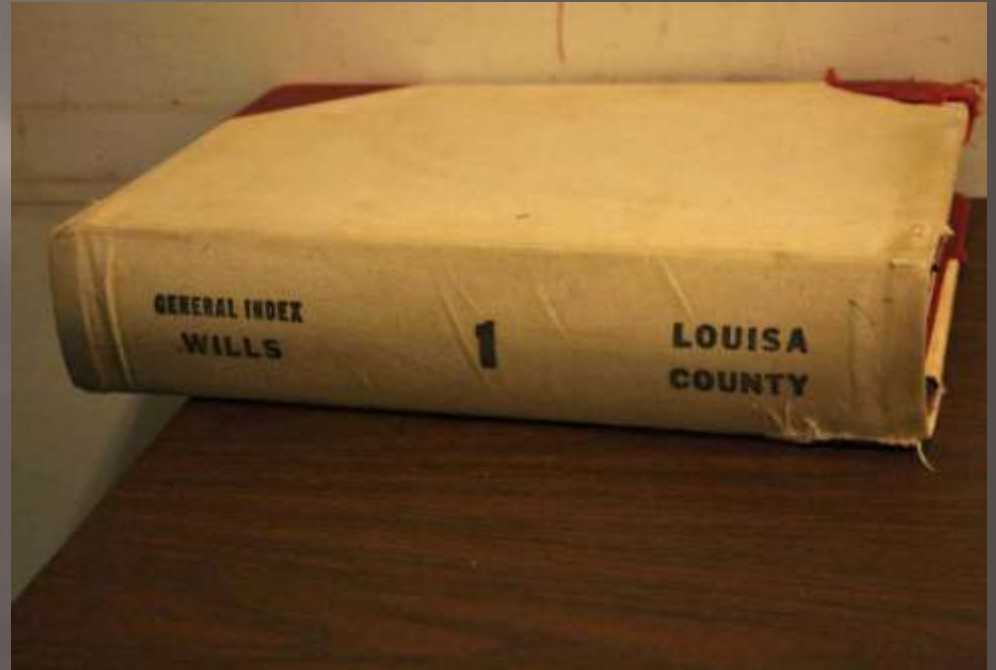

Tax Records

- ❑ Tax records provide data about residency and property, esp. between census years.
- ❑ Personal property records for the first few years following the Revolutionary War are no longer in the courthouse, but are available on microfilm and on CD from Binns Genealogy.



Hints for Tax Records



Both Land and Personal Property records are divided and labeled Northern or Southern districts. The line falls roughly down the middle of the county.



another hint...

WHITES.
The Commissioners of the Revenue will be obliged to list only the WHITE Land owners on the sheets so marked.

TABLE OF TRACTS OF LAND FOR THE YEAR 1893,
County, in Union District, St. J. B. Richardson Commissioner of the Revenue, Assessed with Taxes thereon, at 20 cents
\$100 value thereof for the support of Government, and 10 cents on every \$100 value thereof, for the support of the Public Free Schools.

No.	NAME OF OWNER	SECTION	TOWNSHIP	RANGE	MERCANTILE	ACRES	VALUATION	TAXES	REMARKS	TAXES	
										GOVERNMENT	SCHOOLS
1	Goodman, Mrs. Black, Jr.	Union	Sec.	20	R. 2	11	2.82	72	74	74	74
2	Goodman, Mrs. B. Black	"	"	194	Mc Millan	"	0	2.22	1.75	4.9	2.54
3	Goodman, Hugh	"	"	23	R. 2	6	2.74	10.75	0.2	16	28
4	Barrett, Charlotte, et al	"	"	21	24	10	2	2.00	1.25	3.25	2.01
5	Goodman, J. B.	"	"	194	R. 2	11	2	2.01	1.25	3.26	1.45
6	Goodman, Mrs. Lilla	"	"	21	24	10	2	2.00	1.25	3.25	2.01
7	Goodman, W. H.	"	"	14	10	2	2	2.00	1.25	3.25	2.01
8	Goodman, Mrs. Matt, et al	"	"	14	10	2	2	2.00	1.25	3.25	2.01

By the 1890s, All records are separated by race.

COLORED.
The Commissioners of the Revenue will be obliged to list only the COLORED Land owners on the sheets so marked.

TABLE OF TRACTS OF LAND FOR THE YEAR 1893,
County, in Union District, St. J. B. Richardson Commissioner of the Revenue, Assessed with Taxes thereon, at 20 cents
\$100 value thereof for the support of Government, and 10 cents on every \$100 value thereof, for the support of the Public Free Schools.

No.	NAME OF OWNER	SECTION	TOWNSHIP	RANGE	MERCANTILE	ACRES	VALUATION	TAXES	REMARKS	TAXES	
										GOVERNMENT	SCHOOLS
1	Ward, Mrs. A. J.	Union	Sec.	20	R. 2	11	2.82	72	74	74	74
2	Ward, Mrs. J. B.	"	"	194	Mc Millan	"	0	2.22	1.75	4.9	2.54
3	Ward, Mrs. J. B.	"	"	23	R. 2	6	2.74	10.75	0.2	16	28
4	Ward, Mrs. J. B.	"	"	21	24	10	2	2.00	1.25	3.25	2.01
5	Ward, Mrs. J. B.	"	"	194	R. 2	11	2	2.01	1.25	3.26	1.45
6	Ward, Mrs. J. B.	"	"	21	24	10	2	2.00	1.25	3.25	2.01
7	Ward, Mrs. J. B.	"	"	14	10	2	2	2.00	1.25	3.25	2.01
8	Ward, Mrs. J. B.	"	"	14	10	2	2	2.00	1.25	3.25	2.01

From Union County, Va.
and was sold for \$1000
from John Thompson, Jr.

Misc. Records and Microfilm

- ▣ The room to the right downstairs contains various court books, Board of Supervisors minutes, and the microfilms.
- ▣ The index to the records is filled with thousands of names.

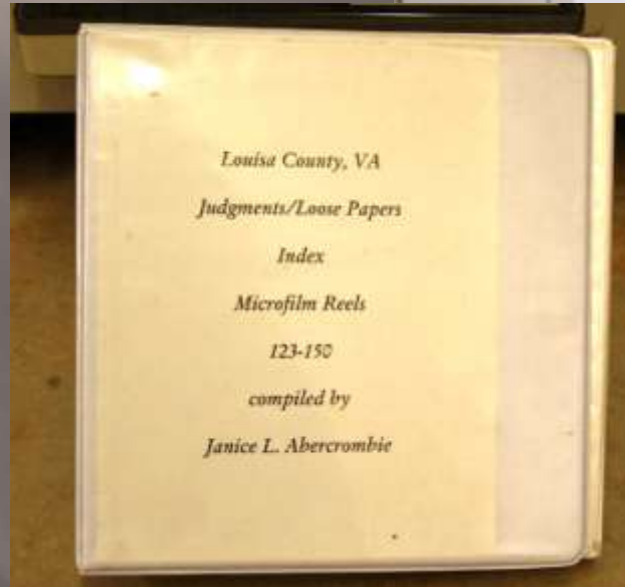

The film reader

The reader is tricky to load, but directions are on it. It operates with the control switch shown here. The films are in the drawer case by the film reader.



Copying images

The printer on the reader no longer works, but a photo of the image comes out quite well, even with a cell phone camera.



As you leave

*Please remember to stop at the window
as you exit and pay for copies.*

The fee is 50 cents per page.

*Additional resources for local history and families can be found at the
Sargeant Museum and Louisa County Public Library.*

A map can be downloaded from the [Historical Society](#).

For more assistance

You can download a brochure from the Historical Society with a map to the courthouse, library and museum [here](#) .

We also have an genealogy website loaded with information maintained by Mr. Wayne Dunn at www.trevilians.com

The Louisa County Historical Society

The Sargeant Museum
214 Fredericksburg Avenue
(mailing- P.O. Box 1172)
Louisa, Virginia 23093

www.louisahistory.org

540-967-5975 or email us at

louisahistory@verizon.net